



THE PRINCESS PAVILION FALMOUTH MEETINGS & EVENTS BROCHURE

PRINCESSPAVILION.CO.UK

 facebook.com/PrincessPavilion

 instagram.com/princesspavilionofficial

VENUE INFORMATION

Thank you for considering the Princess Pavilion for your event. Please find to follow information about the venue, capacities and hire fees.

EXCLUSIVE WHOLE VENUE HIRE

If you choose to book exclusive venue hire the building will be closed to the public. You will have access from 10am - 11pm with exclusive use of the theatre and all back of house areas including three green rooms, Garden Room, bar, gardens and bandstand.

Venue spaces are also available to book separately.

THE GARDEN ROOM

The perfect choice for a smaller event, with beautiful views of the gardens in a light, airy space.

CAPACITIES

X 200 standing
x104 seated at round tables, 8 people per table
x 80 seated at long tables

GET IN TIME

Available from 5pm - 11pm.

THE GARDEN ROOM & BAR

CAPACITIES

X 300 standing
Seated capacities as above.

GET IN TIME

Available from 5pm - 11pm.

THE THEATRE

CAPACITIES

X 600 standing
X 360 seated - 180 on the rake and 180 on the flat floor
x 176 seated at round tables, 8 people per table

GET IN TIME

Available from 10am - 2pm or from 2pm - 11pm.

DRESSING ROOMS

There are three dressing rooms adjacent to the stage. They can be used as green rooms for your VIP guests or breakout meeting spaces.

Dressing Room 1 - 7m x 4m

Dressing Room 2 - 6m x 4m. Has a private toilet and shower facilities.

Dressing Room 3 - 6m x 4m. Has a private toilet and an accessible shower.

There is a refrigerator in each dressing room and tea/coffee making facilities.



FLOOR PLAN

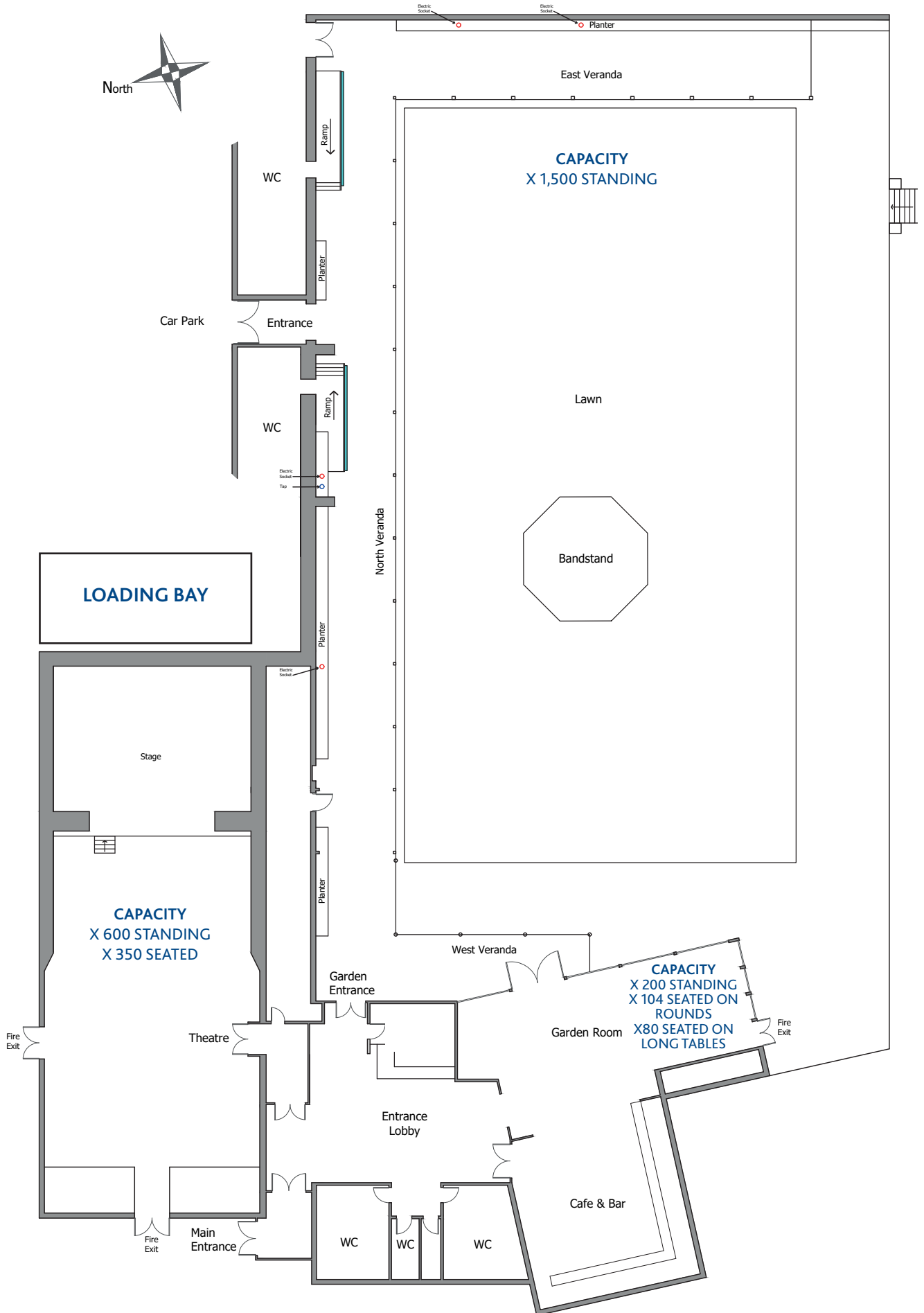

Princess Pavillion
Scale 1:200

CONTACT DETAILS

CONTACT THE EVENTS TEAM FOR MEETING & EVENTS BOOKINGS.

PRINCESS PAVILION, 41 MELVILL ROAD, FALMOUTH, CORNWALL TR11 4AR
TEL: 01326 211222

EMAIL

PAVILIONEVENTS@FALMOUTHTCOUNCIL.COM

WEBSITE

PRINCESSPAVILION.CO.UK

FACEBOOK

FACEBOOK.COM/PRINCESSPAVILION

INSTAGRAM

INSTAGRAM.COM/PRINCESSPAVILIONOFFICIAL

